

ENVIRO®

Single Sliding Horizontal Food Processing Cooler Door Manual or Power Operated

Data Sheet

Model 340 LXP (*Manual*)
Model 350 LXP (*Power*)



Shown with Optional Vision Panel

OPTIONAL EGRESS BREAKAWAY FEATURE

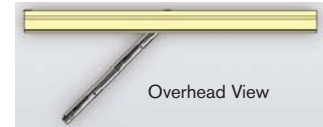

Breakaway View

FEATURES

- High strength 1-3/4" thick lightweight seamless (no center seam) gel-coated laminated fiberglass panel for easy cleaning. Stainless steel (20 gauge) edge capping for added strength and protection.
- Corrosion-resistant, heavy-duty door hardware.
- Recessed stainless steel pull handles.
- Top/bottom guidance system positively maintains door seal and position. Ensures fast, controlled operation with minimal gasket wear.
- Adjustable panel hardware for in-field adjustments. Maintains a positive and tight seal.
- Full perimeter, non-marking, non-shedding, non-absorptive gray vinyl blade-type gasket capable of holding a seal under positive/negative pressure.
- **NO** hardware mounted into floor.
- Optional vision panel with sloped one piece stainless steel frame; no visible fasteners.
- Stainless steel sloped shroud conceals rail (and operator on powered model).
- All visible stainless steel is 304, #4 finish (316 stainless steel optional).

Power model also includes:

- Electromechanical operator with integrated control panel, completely self-contained within shroud.
- Specially designed gearless, oil-free belt drive. Manual operation during unexpected power failures.
- High strength non-shedding, non-absorptive fiberglass reinforced drive belt for quiet reliable operation.
- Torque sensing reversing capability on both the opening and closing cycles.
- Two send and receive reversing photoeyes in the side frame.



Model 340 LXP Shown

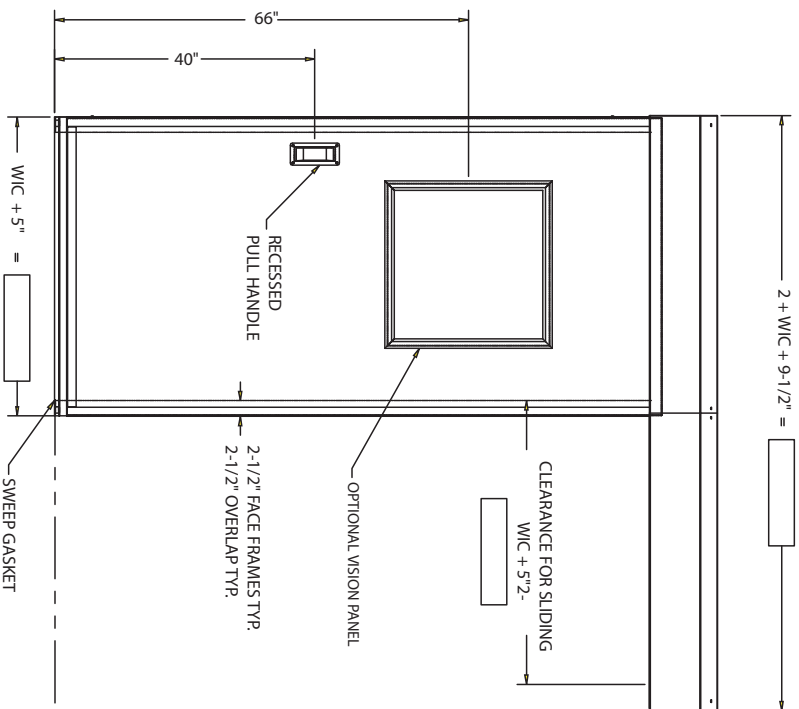
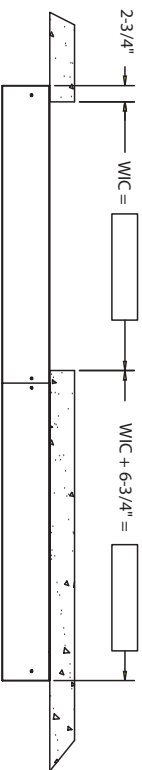

Note: With Breakaway Feature: HIC + 14-1/2"

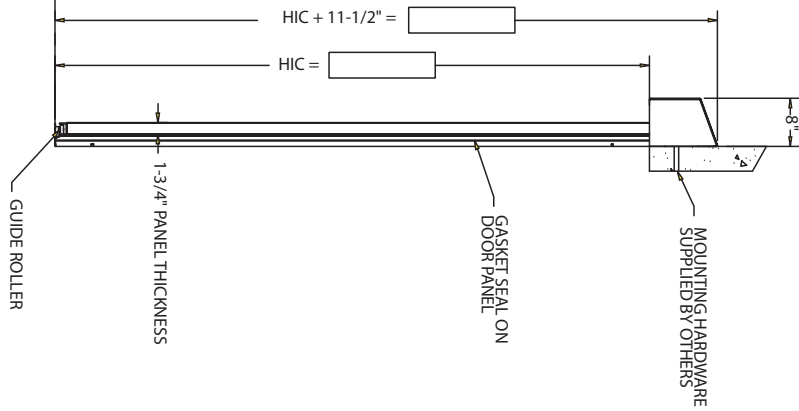

DESIGN AND CONSTRUCTION STANDARD SIZES

- To maintain the integrity of a seamless (no center seam) construction, the following restrictions apply:
 - Up to 1'0" high if maximum width of opening is 7'7" or less.
 - Up to 8'7" wide if maximum height of opening is 8'0" or less.
 (Other sizes available -Consult factory.)

PANEL CONSTRUCTION

- Gel-coated fiberglass sheet laminated to an expanded polystyrene core material.
- 20 gauge stainless steel edge capping.
- Full perimeter, non-marking, non-shedding, non-absorptive gray vinyl blade type.

OPERATION

- Powered model has 1/8 h.p. electromechanical operator. (Open-24"/sec. - Close-18"/sec.).
- Gearless, oil-free drive.

PERFORMANCE FEATURES

- Torque sensing stop/reverse both in the open and closing cycles.
- (2) Send & receive reversing photoeyes.

WARRANTY

- One year on all components.

OPTIONS

- Manual operation.
- Stainless steel clad panel.
- Vision panel (optional sizes).
- Swinging egress panel available.
- Stainless steel rail.
- Stainless steel roller truck.
- 20 gauge stainless steel kickplates on door panel.

(Power Models Only)

- Touchless wall-mounted activation switch.
- Actuators: Pull cord; photoeye; radio control; loop detector; motion detector; or O/C/S pushbutton.
- Interlock system.
- Electronic lock.
- Washdown grade operator.



For complete Architectural Specifications contact ASI or visit www.asidoors.com



5848 N. 95th Court • Milwaukee, WI 53225 • (414) 464-6200 • (800) 558-7068 • FAX: (414) 464-9863 • www.asidoors.com
 Consistent with our policy of continued product improvement, we reserve the right to change product specifications without notice or obligation.

340-350 LXP 1/2004R

©2003, ASI TECHNOLOGIES, INC. • PRINTED IN U.S.A.